

TACME®

The Ideal Ventilation Fans™

VENTILATING FANS



**Ceiling
Mount Type**



**Window
Mount Type**



**Wall
Mount Type**

VENTILATING FANS

Window and Wall Mount Fans

- High-quality engineering plastics, dust proof and unique static resistance
- The leak-proof structure is compact, light weight, and good looking

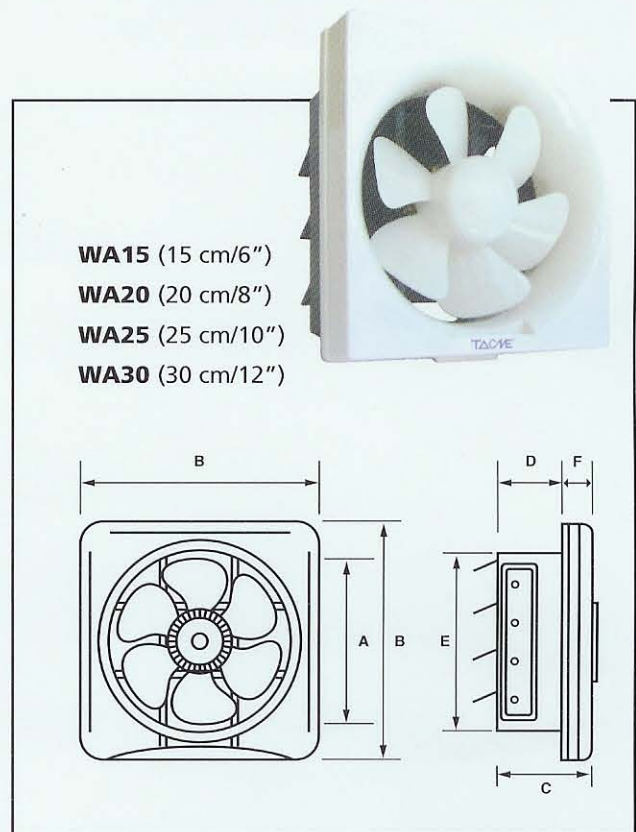

Specifications

Model	Air Volume		Speed	Input	Power Supply	Noise	Weight	Dimensions (Mm.)							
	CFM	CMH	RPM	(Watt)	V/PH/Hz	dB(A)	(kg.)	A	B	C	D	E	F	G	H
Wi15	118	200	1500	19	220/1/50	39	0.77	150	210	80	72	180	35	32	142
Wi20	282	480	900	20	220/1/50	41	1.54	200	270	96	86	238	41	37	190
Wa15	170	290	1350	23	220/1/50	39	1.20	150	239	125	83	188	42	-	-
Wa20	318	540	1250	26	220/1/50	40	1.40	200	296	125	82	240	43	-	-
Wa25	530	900	1200	30	220/1/50	42	2.00	250	342	128	84	290	44	-	-
Wa30	734	1250	1050	40	220/1/50	44	2.20	300	400	140	92	340	48	-	-

Ceiling Mount Fans

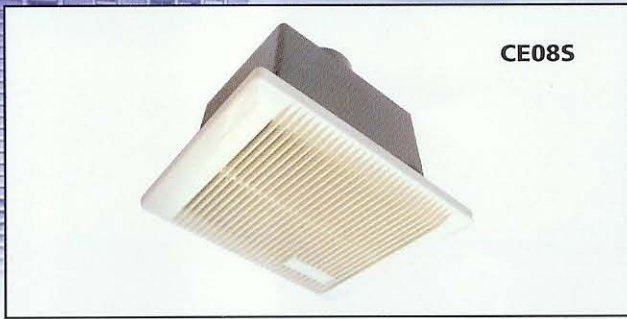

Specifications

Model	Air Volume		Speed	Input	Power Supply	Noise	Weight
	CFM	CMH	RPM	(Watt)	V/PH/Hz	dB(A)	(kg.)
CE08S	46	78	1190	19	220/1/50	38	2.00
CE09	88	150	1150	25	220/1/50	42	1.80
CE10	68	115	600	22	220/1/50	37	4.25
CE15	100	170	750	25	220/1/50	39	4.88
CE20	132	225	1115	28	220/1/50	40	4.88
CE25	156	265	510	31	220/1/50	40	7.25
CE32	188	320	570	37	220/1/50	42	7.25
CE40	253	430	720	58	220/1/50	43	7.63
CE60	365	620	810	85	220/1/50	46	10.00

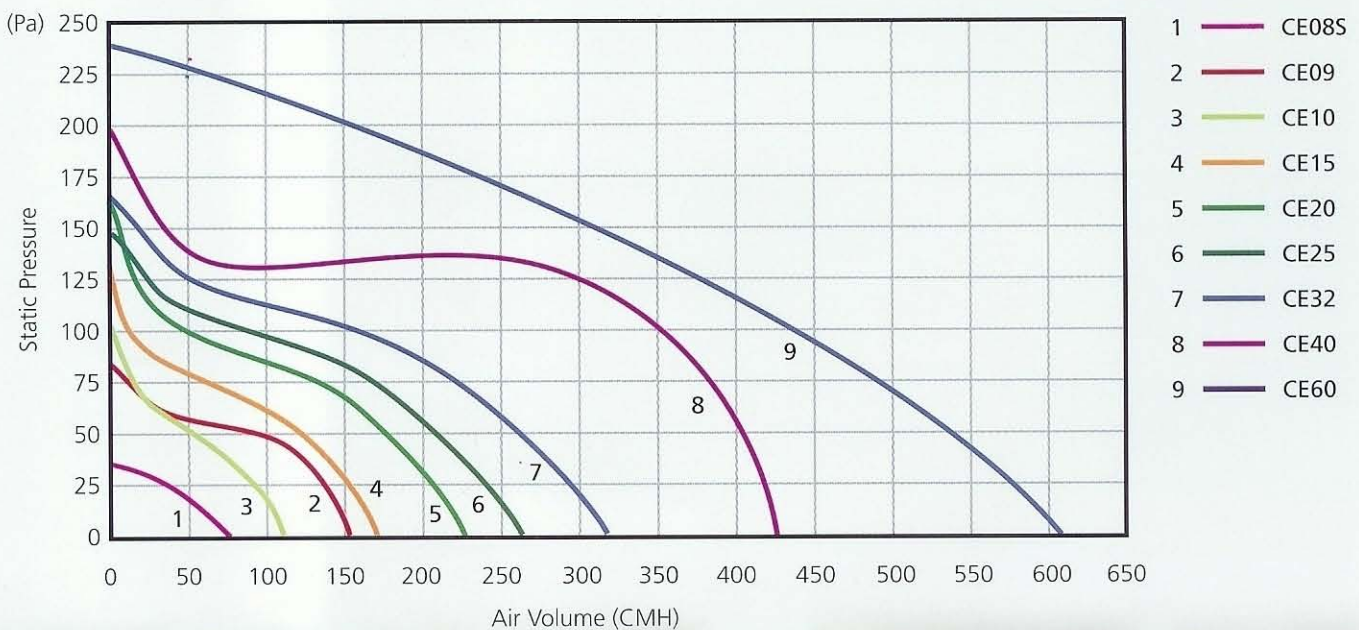

- 1 The instant-insert dismantling vent is more convenient for ducting, installation, dismantlement and maintenance.
- 2 Anti-reflex vent sheet, anti-reverse flow, improve the hermetic seal.
- 3 The terminal box-hole design ensures conveniently power supply connecting and maintenance
- 4 Elegant inlet panel is fluid characteristic design. The design of clamping spring connection ensures easy installation, dismantlement and cleaning.
- 5 The body is weld joint tech finished, special workmanship coating, heavy-duty, rustproof and good hermetic seal
- 6 The ball bearing motor ensures low noise, maintenance free, permanent quality guarantee.
- 7 High performance large angle and large width centrifugal fan wheel, ensures high static pressure and air volume.

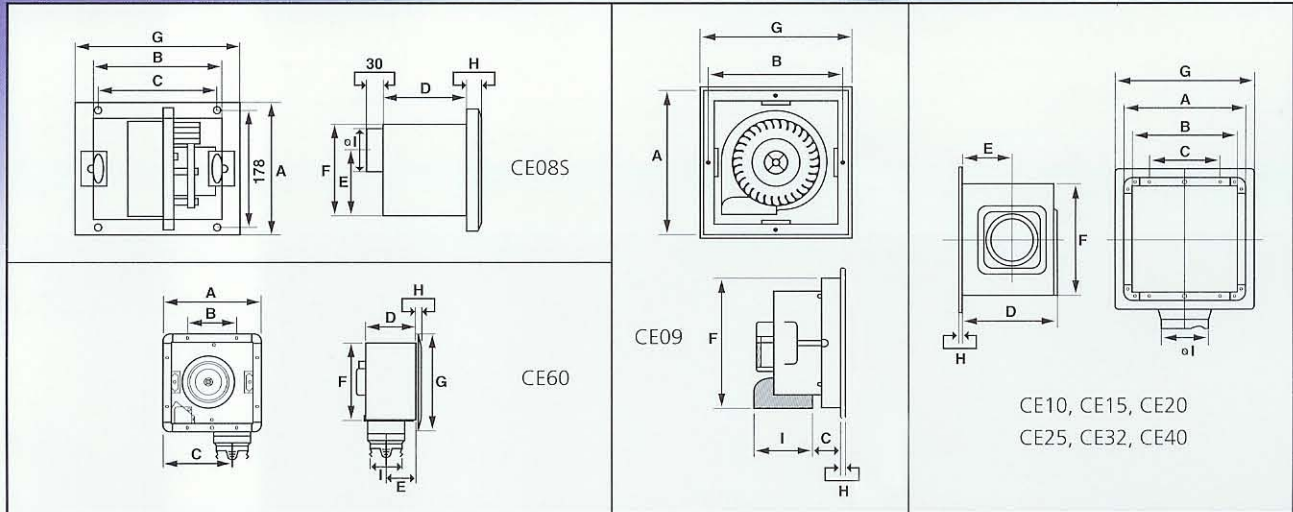

Dimensions (mm.)

Model	A	B	C	D	E	F	G	H	I
CE08S	200	195	80	140	110	152	249	13	74
CE09	265	245	60	-	-	227	278	13	97
CE10	202	190	90	185	120	170	256	13	74
CE15	269	254	140	200	108	230	300	14	98
CE20	269	254	140	200	108	230	300	14	98
CE25	309	290	180	240	128	270	333	14	148
CE32	309	290	180	240	28	270	333	14	148
CE40	309	290	180	240	128	270	333	14	148
CE60	424	255	295	227	139	375	450	20	145

Accessories



STAINLESS



OSM

USH



ALUMINIUM



PAINT STEEL